



The Island Quarter, Phase 1A, Nottingham

Contractor

Sir Robert McAlpine

Steel Tonnage

54 tonnes

Steel frame on to concrete structure, drill and fix to concrete, feature steel staircase and metal decking

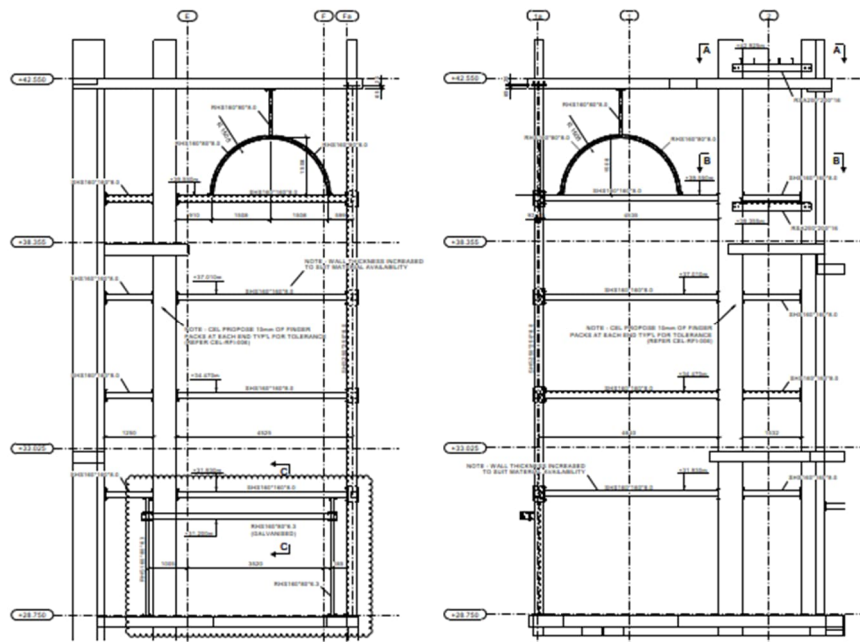

Caunton Engineering Ltd.

Caunton House, 2 Coombe Road, Moorgreen Industrial Park, Newthorpe, Nottingham NG16 3SU

▲ T. 01773 531111 ▲ E. sales@caunton.co.uk ▲ W. www.caunton.co.uk

CF0139

